

# The **S**OUNDER

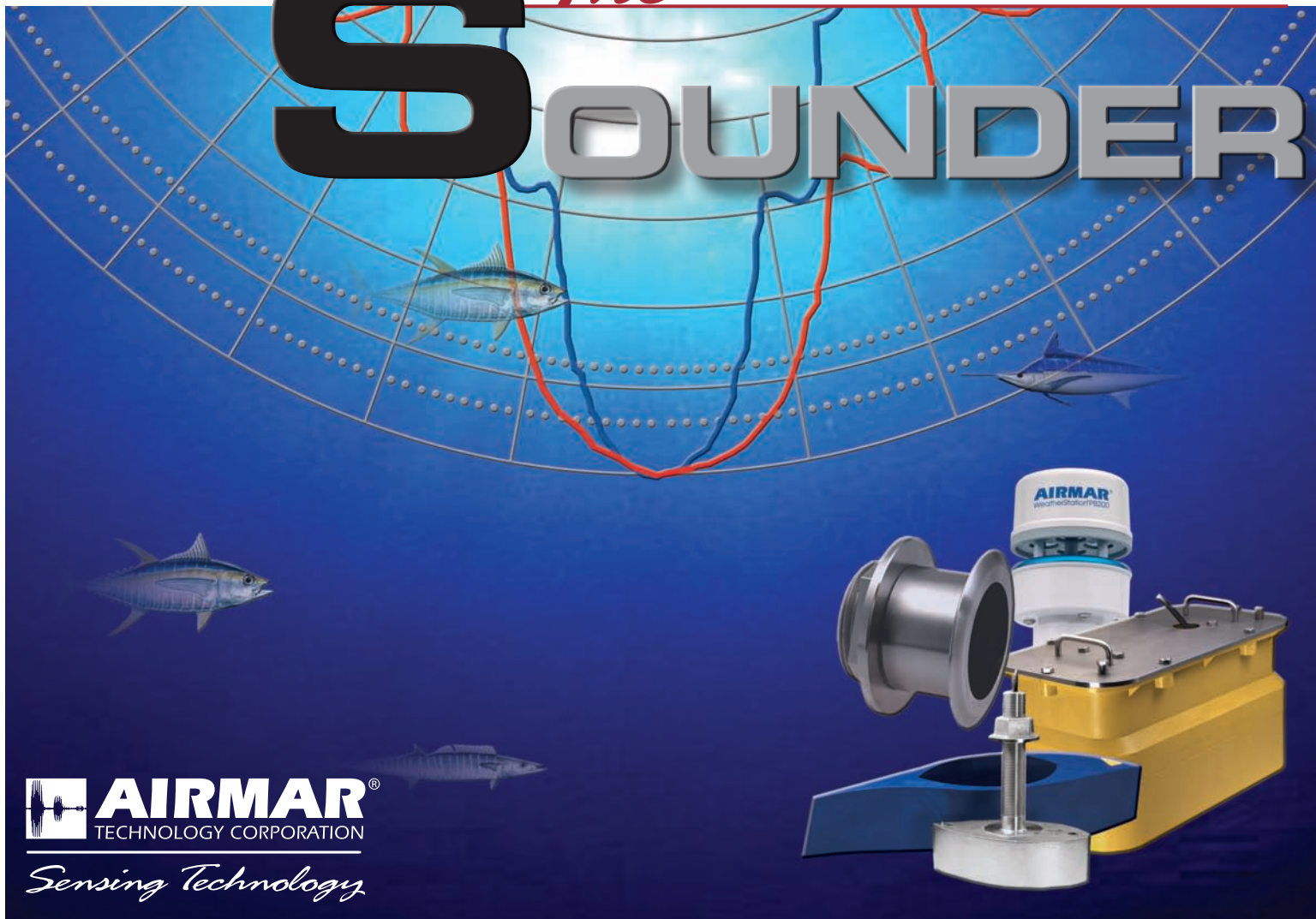

**AIRMAR**<sup>®</sup>  
TECHNOLOGY CORPORATION

*Sensing Technology*

## Welcome

The Sounder is Airmar's quarterly newsletter that presents our newest innovative products, offers hands-on installation tips, explains our quality features, and acquaints OEMs, installers, and the press with our company's resources.

### Fall 2008 Features

- Shipment update—PB200 WeatherStation<sup>®</sup> Instrument and SS264 Transducer Pairs
- NMEA Transducer Presentation & Transducer Editor Demo
- New GH2183 GPS / Heading Sensor
- NEW Enhanced Water Temperature Sensor on All 1kW Models
- Airmar Trade Show Schedule

If you know someone who would like to receive this informative newsletter, or if you would like to unsubscribe, please e-mail [mreedenaer@airmar.com](mailto:mreedenaer@airmar.com).

---

**Now Shipping—  
PB200 WeatherStation<sup>®</sup> Instrument  
and SS264 Tilted Element<sup>™</sup> Pairs**

## **PB200 WeatherStation Instrument—Precise marine data you need—Wind, Weather, Heading, and Navigation**

- True and apparent wind speed and direction
- Barometric pressure
- Air and wind chill temperature
- Measures wind speed and direction ultrasonically
- Internal WAAS GPS
- Three-axis solid-state compass
- Three-axis accelerometer provides pitch and roll information
- Outputs both NMEA 0183 and NMEA 2000®
- WeatherCaster™ Software
- Better than 1° compass accuracy in static conditions
- Best-in-class 2° compass accuracy in dynamic conditions
- Yaw rate gyro provides rate-of-turn data
- Very easy installation and two-year warranty
- Maintenance-free operation—no moving parts
- Applications—Large powerboats and commercial vessels



## **SS264 Tilted Element Pairs—Get the ultimate, 1kW, thru hull performance without installing a fairing block!**

### **SS264W, 1kW, Wide-Beam Pair**

- Consists of two transducers
- 50 kHz wide-beam
- 200 kHz wide-beam
- Designed for tuna and marlin fishing

### **SS264N, 1kW, Narrow-Beam Pair**

- Consists of two transducers
- 50 kHz wide-beam
- 200 kHz narrow-beam
- Designed for tuna/marlin fishing and superior bottom fishing performance

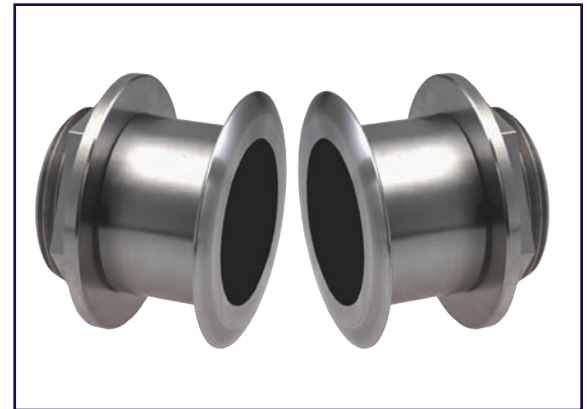

The SS264W and SS264N can be purchased as a pair for dual-frequency operation or individually as single-frequency units. The SS264's ceramic elements are tilted inside the housings, which compensates for your boat's deadrise. This aims both transducer beams straight toward the bottom, resulting in strong echo returns and accurate depth readings.

Contact your electronics manufacturer, local NMEA dealer, Gemeco, or Airmar EMEA for pricing and availability. To learn more, visit [www.airmar.com](http://www.airmar.com).

---

# **NMEA Transducer Presentation and Transducer Editor Demo**

Airmar will be presenting a Transducer Technology presentation at the NMEA Tradeshow on Wednesday, October 1 at 1pm and 3pm at the Town & Country resort in San Diego, California. The presentation is geared towards sales and installers alike. All are invited to attend and ask any transducer questions.

### **Editors Take Note:**

Airmar will have a test boat at the NMEA show for deep-water transducer demonstrations. We will be making Thursday and Friday morning trips from 6am-10am with our popular transducers connected to some popular fishfinders. Space is limited. E-mail [mreedenaer@airmar.com](mailto:mreedenaer@airmar.com) if you are interested. These trips are reserved for editors only please.



---

# New GH2183— Combines GPS Positioning and Highly-Accurate Heading Information

The GH2183 combines WAAS GPS positioning and highly-accurate heading information in one compact antenna. This revolutionary product eliminates the need to install a GPS antenna above deck and a heading sensor below deck—saving installation time and money. The waterproof housing protects the internal components—all of which are solid-state (no moving parts). This means the GH2183 can withstand the harsh conditions that exist in the marine environment making it the ideal GPS and Heading solution for metal-hulled boats.

What sets the GH2183 above the competition is its better than 1° static heading accuracy, and more importantly, its 2° heading accuracy in dynamically changing conditions—including rough seas, hard turns, and steep heeling. Our unique dynamic motion correction software is the key difference. Heading integrated with the three-axis rate gyro and three-axis accelerometer data allows the GH2183 to maintain 2° of accuracy even if the vessel is pitching and rolling up to 30°. Also unique to the GH2183 is that the three-axis accelerometer and three-axis rate gyro are temperature compensated across the entire operating range resulting in precise tilt and rate-of-turn data. The GH2183 can simultaneously output NMEA 0183 and NMEA 2000® data, making it the best choice for interfacing to autopilots, chartplotters, and radar systems—to dramatically improve their performance. Autopilots will steer straighter than ever before—even in rough seas. Watch as radar targets on the radar screen, or overlaid on the chartplotter, stay in a precise position—even when making fast, sharp turns.

The GH2183 is ideal for use in metal-hulled vessels that can not mount a standard heading sensor below deck. Its rugged sealed construction and solid-state design ensure reliable maintenance-free operation on today's boats, even in the harsh marine environment. To accommodate different vessel configurations, the GH2183 can be easily mounted either on a pole or flush to the deck.

For customers that need a heading only solution, we also offer the H2183 Heading Sensor. The H2183 has all of the same features and benefits of the GH2183, without the GPS sensor. The H2183's innovative circular design allows installers to easily mount and align the H2183 on ANY angled bulkhead—making installation quicker and easier.

To learn more, visit [www.airmar.com](http://www.airmar.com).



GH2183 Pole/Rail-Mount



GH2183 Flush-Mount



H2183

---

## New Enhanced Water Temperature Sensors on All 1 kW and up Models

Beginning in January 2009, all 1kW and up Thru-Hull, Transom-Mount, and Tilted Element™ transducer models will have an exposed copper temperature button. This product enhancement will give fishfinders a quicker temperature response-time than current models due to the button being in contact with the water. This gives fishermen yet another advantage by detecting slight changes in water temperature where gamefish and bait could be lurking. The specific models that will feature this product enhancement are as follows:

- B258 Thru-Hull
- SS270W Thru-Hull
- B260 Thru-Hull
- SS260 Thru-Hull
- R99 Thru-Hull External-Mount
- R209 Thru-Hull External-Mount
- R309 Thru-Hull External-Mount
- SS264N Tilted Element Pairs
- B164 Tilted Element
- SS164 Tilted Element
- SS264W Tilted Element Pairs
- TM258 Transom-Mount
- TM270W Transom-Mount
- TM260 Transom-Mount

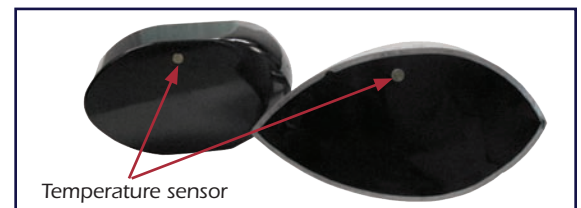

# Airmar Trade Show Schedule

Stop by the Airmar stand at the following shows to check out our exciting new products for 2009:

## **September 30 — Oct 2, 2008**

### **NMEA Convention (National Marine Electronics Association)**

Trade Only Booth # 309

Towne & Country Resort

San Diego California

[www.nmea.org](http://www.nmea.org)

## **October 6-8, 2008**

### **IBEX (International Boatbuilders Exposition)**

Airmar Booth # 540

GEMECO booth # 542

Miami Beach Convention Center

Miami, FL

[www.ibexshow.com](http://www.ibexshow.com)

## **October 21-24, 2008**

### **Shallow Water Survey Show**

University of New Hampshire

[www.unh.edu](http://www.unh.edu)

## **November 15-17, 2008**

### **Pacific Marine Expo**

Washington State Convention Center

Seattle, WA

[www.pacificmarineexpo.com](http://www.pacificmarineexpo.com)

AIRMAR representatives will visit the show but will not be exhibiting.

## **November 18-20, 2008**

### **METS (Marine Equipment Trade Show)**

Trade Only Booth # 01.305

Europa Hall #1, RAI Center

Amsterdam, Netherlands

[www.mets.nl](http://www.mets.nl)

## **February 14-18, 2009**

### **Miami International Boat Show**

[www.miamiboatshow.com](http://www.miamiboatshow.com)

AIRMAR representatives will visit the show but will not be exhibiting.

